

INTERSTATE HIGHWAY NO. 35

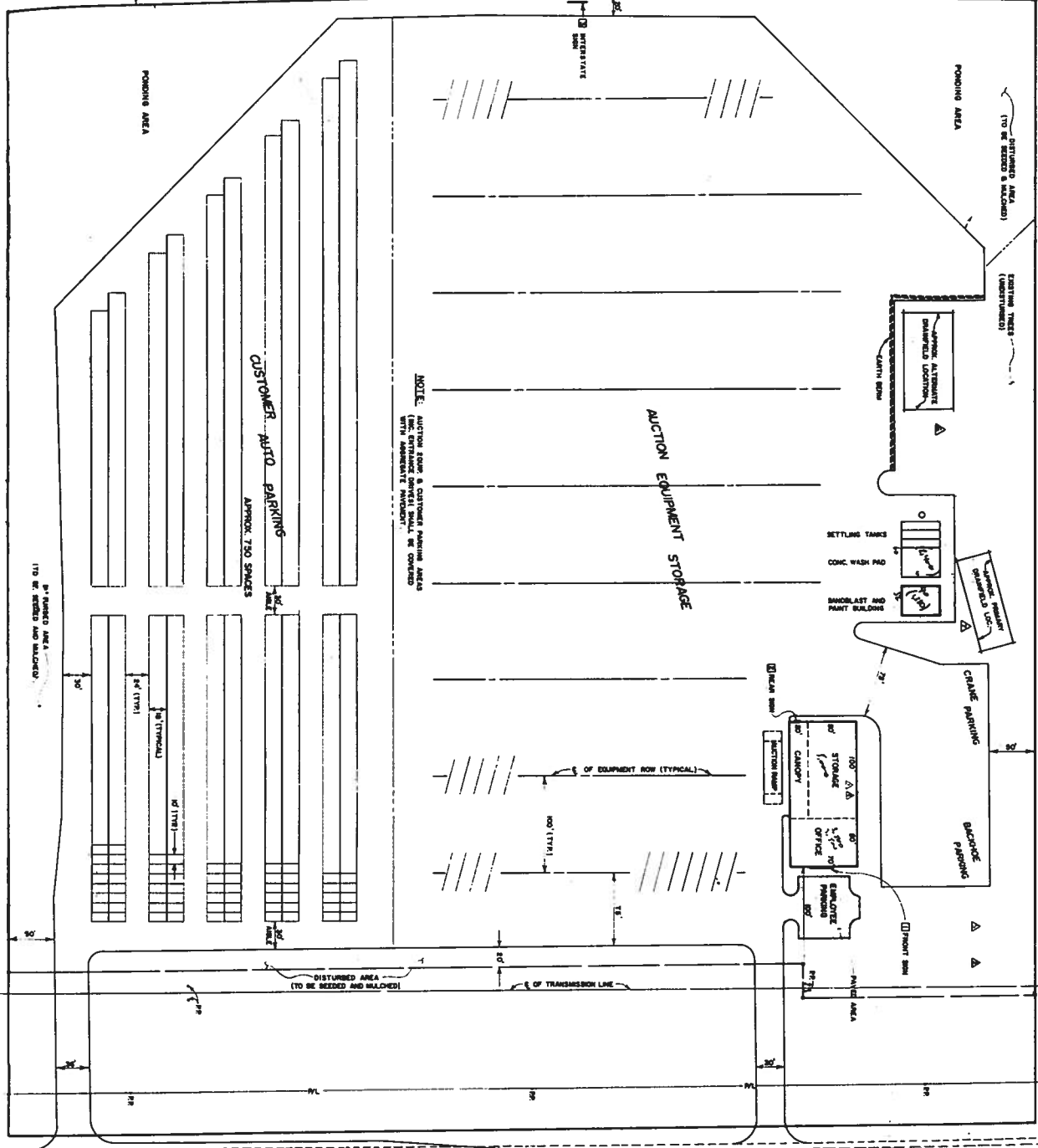

NOTE: AUCTION ROOM & CUSTOMER PARKING AREAS WITH EXISTING TREES SHALL BE COVERED WITH ASPHALT.

COUNTY RD. NO. 46 (PILESBURY AVE.)

6' X 6' SIGN (36 SQ. FT.)  
**RITCHIE BROS. Auctioneers**



REAR OF OFFICE:  
 2' X 24' SIGN (48 SQ. FT.)  
**RITCHIE BROS. Auctioneers**

PROPOSED SIGNAGE:

FRONT OF OFFICE:



**RITCHIE BROS. HEAVY EQUIP AUCTION**  
**SITE LAYOUT**

APPROVED FOR THE YEAR FROM THIS DATE  
 C.E. Engineer

James E. P...  
 5538c-12-10-11

**Valley Engineering Co., Inc.**  
 CONSULTING ENGINEERS & LAND SURVEYORS  
 P.O. BOX 478  
 8520 FRANKLIN TRAIL OFFICE CONDOMINIUM  
 VALLEY ENGINEERING & LAND SURVEYING

DATE	DESCRIPTION

SCALE: 1" = 20'  
 SHEET NO. 1 P. 5

Keppel Tener Real Estate Services, Inc. Valuation Division